

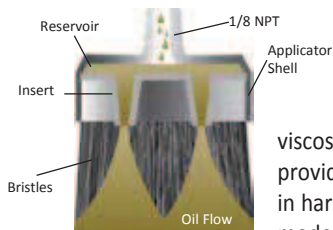

APPLICATORS

EVEN-FLO® APPLICATORS



The unique internal reservoir design of these applicators allow uniform dispensing of oil for chain lubrication. They are capable of handling a wide viscosity range of oils. Stainless steel models provide long life and excellent cleaning capability in harsh environments. Nylon and stainless steel models rated to 160°F.

SELECTION CHART (1/8 NPT connections)

Model No.	Bristle Type
36051	Nylon
36054	Stainless Steel

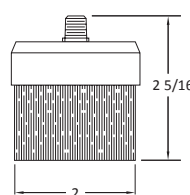

EVER-LAST® APPLICATORS



Patented Ever-Last applicators use four part construction to provide long life in the most demanding applications. Using ordinary shears, they may be trimmed to fit the exact size of chain and eliminate uneven wear of the applicator or side dripping of the lubricant. Using a Buna-N cover and felt plate, the mechanical motion of the chain movement sets up a pumping action in the applicator. Temperature rating of 200°F.

SELECTION CHART (1/8 NPT connections)

Model No.	Width (in.)
36033	1-1/4
36036	2

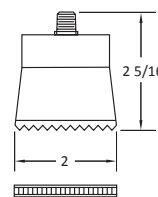
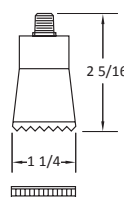

ROUND BRUSH APPLICATORS



Trico round brushes are used in applications requiring broad contact surfaces for lubricating and cleaning. They offer even oil distribution on the wearing points of chain. Stainless steel models provide long life and excellent cleaning capability in harsh environments. Nylon and stainless steel models rated to 160°F.

SELECTION CHART (1/8 NPT connections)

Model No.	Size (in.)	Bristle Type
36039	5/8	Nylon
36042	5/8	Stainless Steel
36045	1	Nylon
36048	1	Stainless Steel

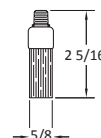
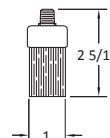

ROTARY APPLICATORS



Trico rotary applicators are used to lubricate and clean chains. Available with a 3 inch nylon or stainless steel rotary brush, they provide chain driven cleaning or lubricating at the speed of the chain. They may be mounted in any orientation to the chain, but when located under the chain they are only used for cleaning. Nylon brushes rated for temperatures to 250°F and stainless steel models rated to 400°F.

REPLACEMENTS—BRUSHES

Model No.	Description
36090	3" Nylon Rotary Brush (1 pair)
36093	3" Stainless Steel Rotary Brush (1 pair)

REMOTE ROTARY BRACKET FOR 1/4" TUBE

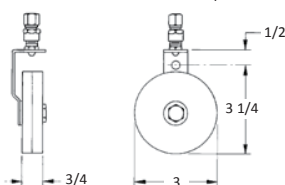

Model No.	Bristle Type
36072	Nylon
36075	Stainless Steel

ACCEPTS
1/4 O.D. TUBE
5/16 MOUNTING
HOLE

REMOTE ROTARY BRACKET/VALVE ASSEMBLY

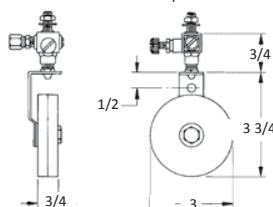

Model No.	Bristle Type
36084	Nylon
36087	Stainless Steel

ACCEPTS 1/4 O.D.
TUBE 5/16-18
MOUNTING STUD
5/16 MOUNTING
HOLE

ROTARY BRACKET ASSEMBLY WITH MOUNTING STUD

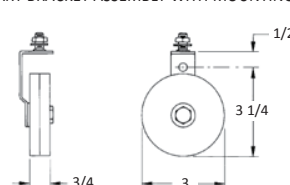

Model No.	Bristle Type
36078	Nylon
36081	Stainless Steel

5/16-18
MOUNTING STUD
5/16
MOUNTING HOLE